

## Engineering Data Sheet

### TIC0402 – 2" Thermal Isolator Clip

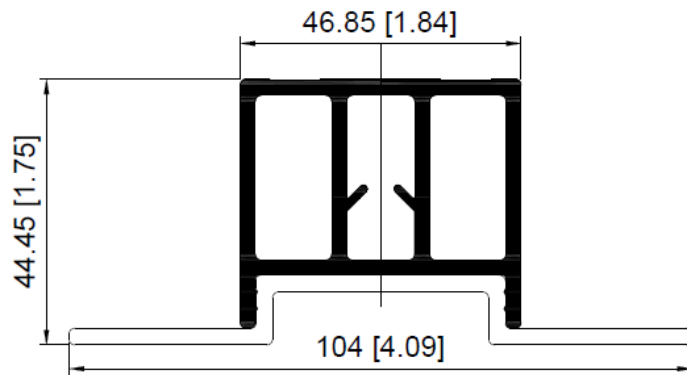

\*Dimensions = inches [mm]

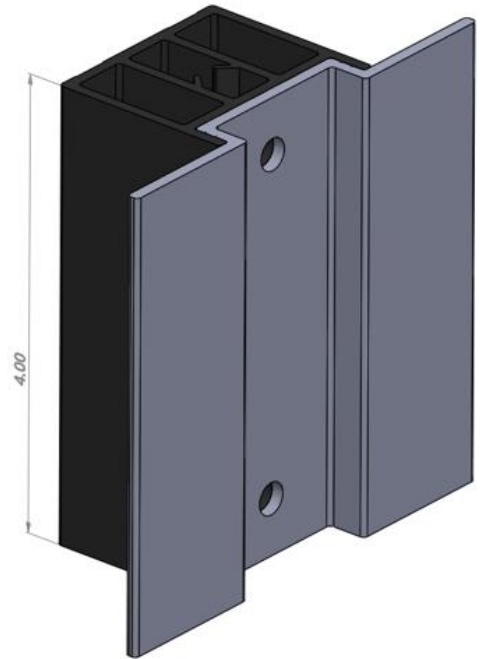

#### Sectional Properties of the TIC0402

|  |   |
|--|---|
| <b>Profile Depth</b>                                 | 1.75"   |
| <b>Material</b>                                      | 40% glass-filled polyamide, 6063-T6 alloy and temper                |
| <b>Area</b>  | 1.42 in <sup>2</sup>  |
| <b>Centroid relative to output coordinate system</b> | y = -0.15   |
| <b>Moments of inertia, at centroid</b>               | I <sub>x</sub> = 0.47, I <sub>y</sub> = 1.01, I <sub>z</sub> = 1.48 |
| <b>Material properties: 40% GF polyamide</b>         |   |
| <b>Compressive stress</b>                            | 910,639 lb/in <sup>2</sup>  |
| <b>Flexural Stress</b>                               | 32,768 lb/in <sup>2</sup>   |
| <b>Transverse tensile stress</b>                     | 13,408 lb/in <sup>2</sup>   |
| <b>Young's modulus</b>                               | 452,988 lb/in <sup>2</sup>  |